

Assembly Instructions

Model: BED 8006
1540 X 2040

Part List		QTY
1	Headboard	1
2	Footboard	1
3	Side Rail	2
4	End Holder	26
5	Middle Holder	13
6	Slat 745mm	26
7	Pump Mounting Bracket	2
8	Bracket Base	2
9	FB / SR Angle Bracket	2
10	Main Frame (Front & End)	2
11	Main Frame (Side)	2
12	Center Rail	1
13	Metal Corner Bracket	4
14	Rubber Corner Connector	4
15	Support Legs 215mm	1
16	Gas Spring	2
17	Stopper	1
18	Black Woven	1

Hardware		QTY
A	JCBC M6 X 20 (Black)	8
B	JCBC M6 X 40 (Black)	8
C	JCBC M6 X 50 (Black)	18
D	JCBB M8 X 50 (Black)	10
E	M6 Spring Washer (Black)	52
F	M6 Flat Washer (Black)	52
G	M6 Hex Nut (Black)	18
H	M8 Spring Washer (Black)	20
I	M8 Flat Washer (Black)	20
J	M8 Hex Nut (Black)	10
K	M4 Allen Key	1
L	M5 Allen Key	1
M	M6 Spanner	1
N	M8 Spanner	1
O	Frame lifter	1
P	Adjuster	1
Q	JCBB M8 X 20	8
R	White Nail	8
S	CSK M4x32 BLACK	8

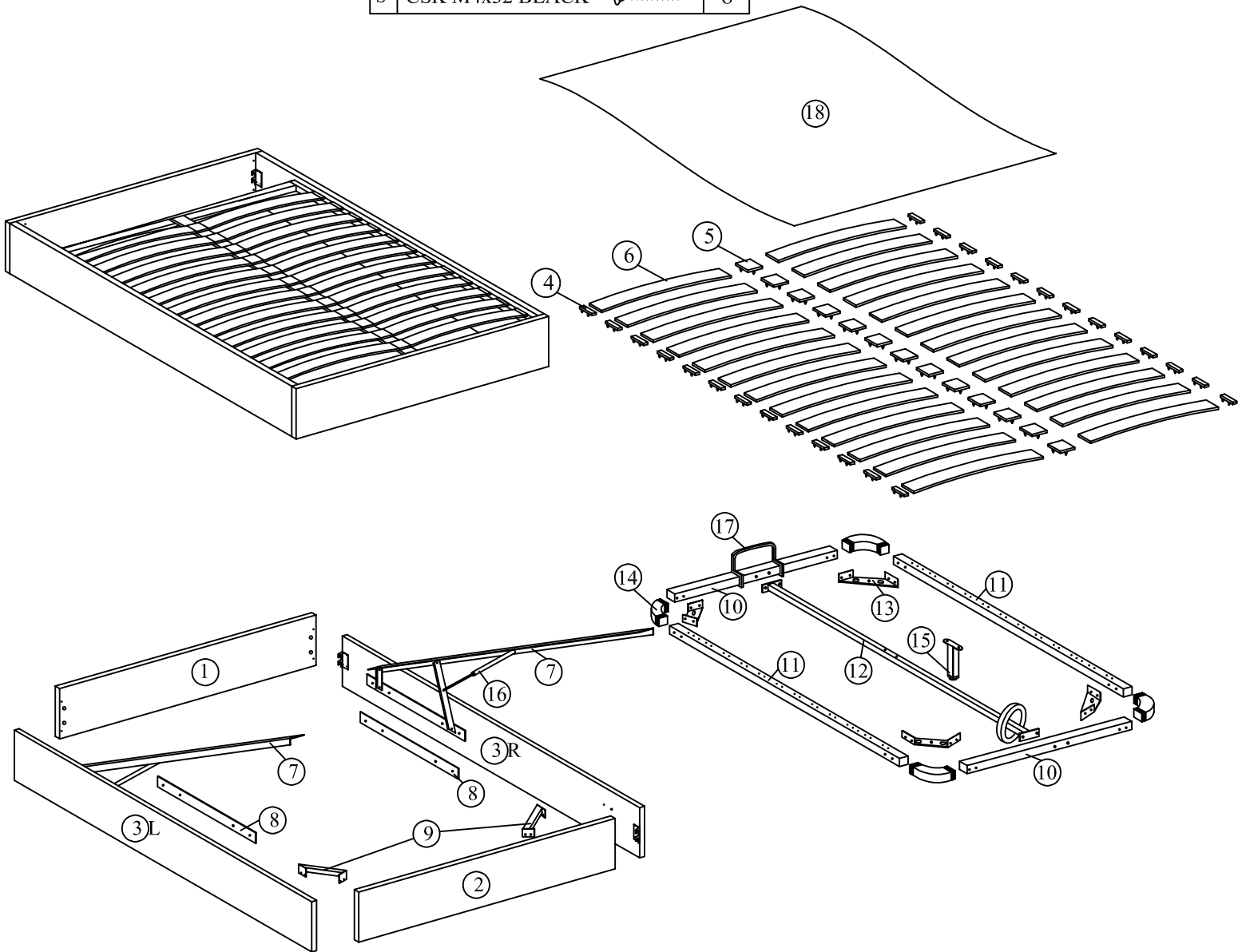

Step 1

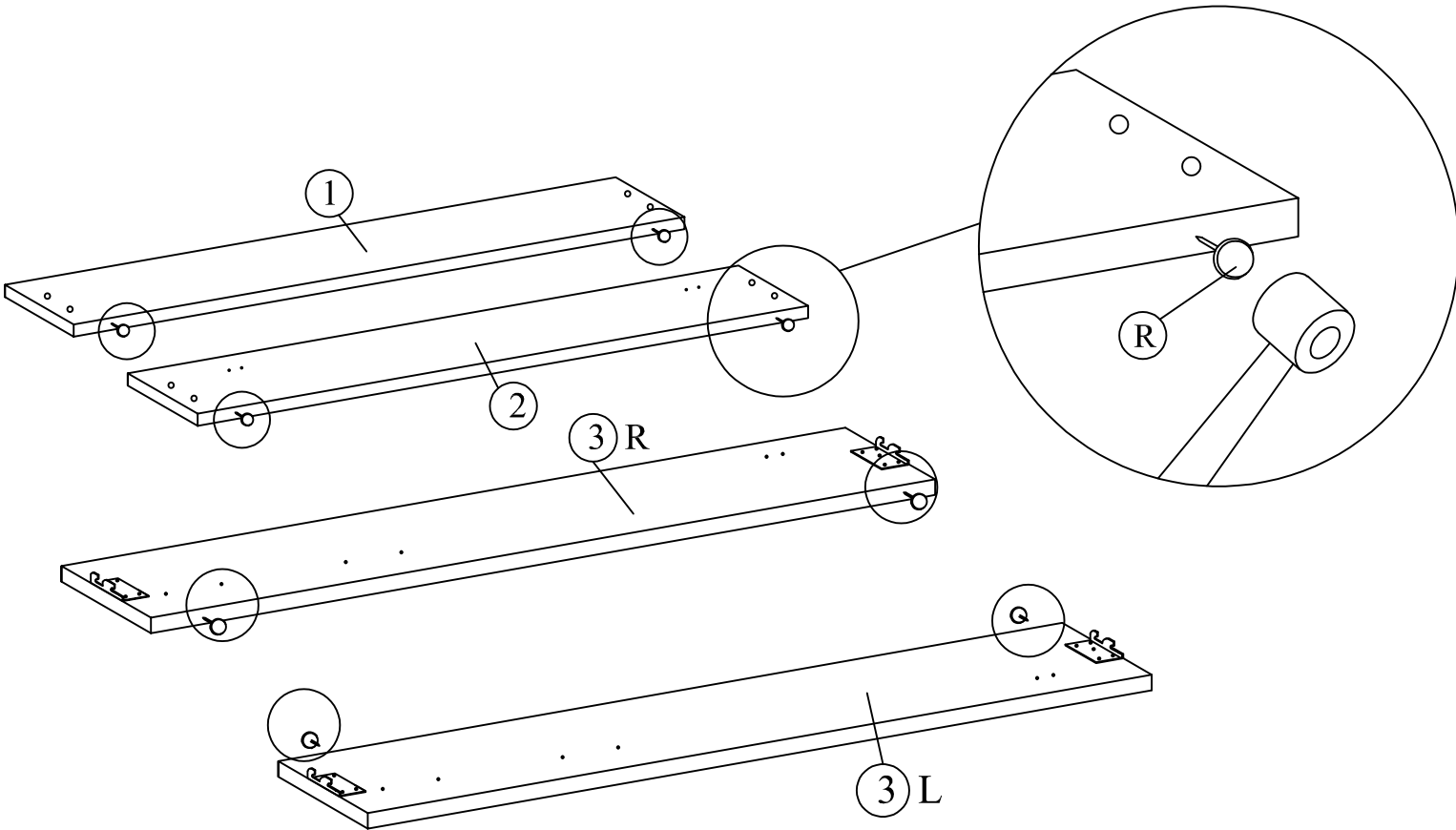

Step 2

IMPORTANT: Part 8 base bracket **MUST BE ATTACHED** before attaching Part 7 the pump mounting bracket.

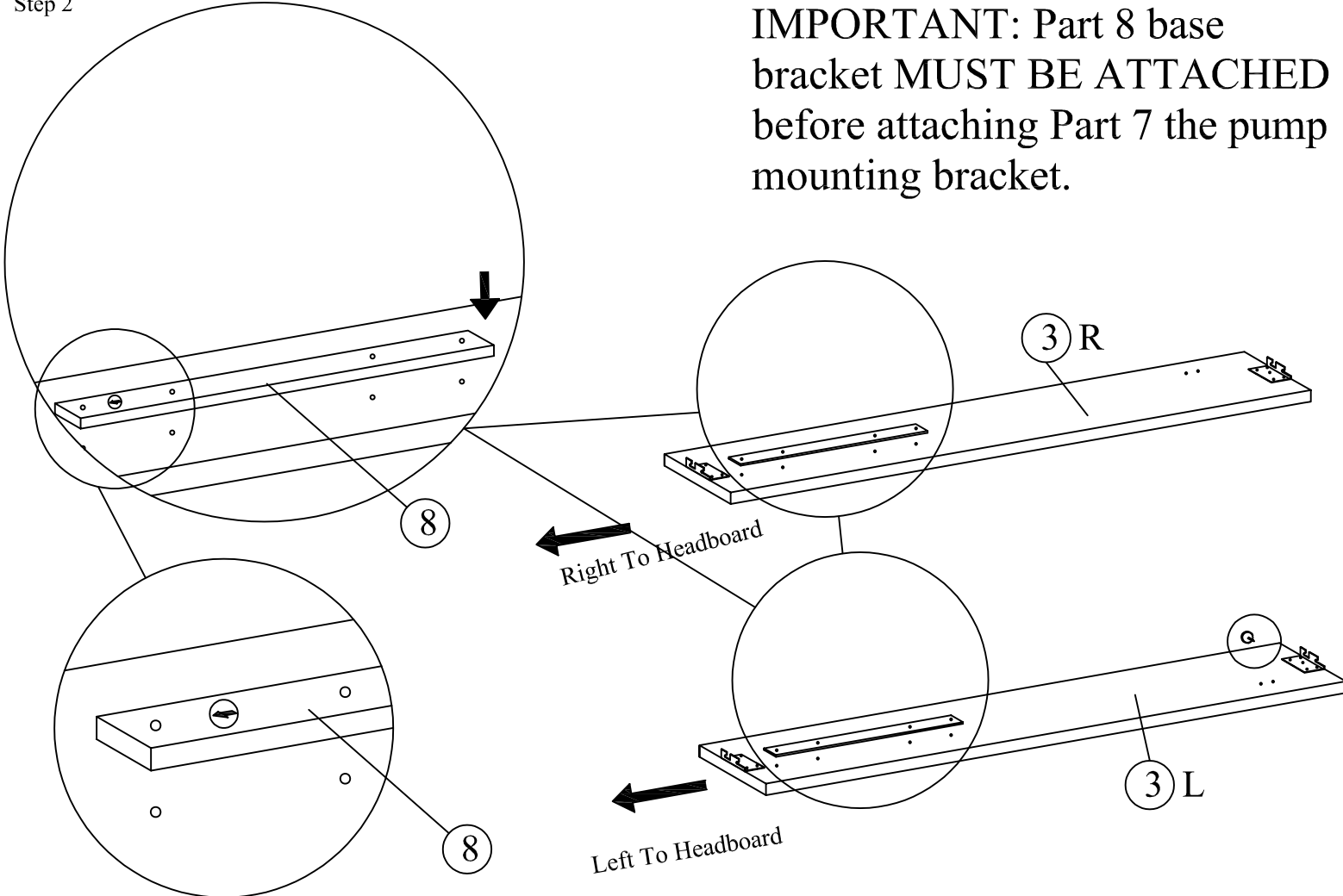

Step 3

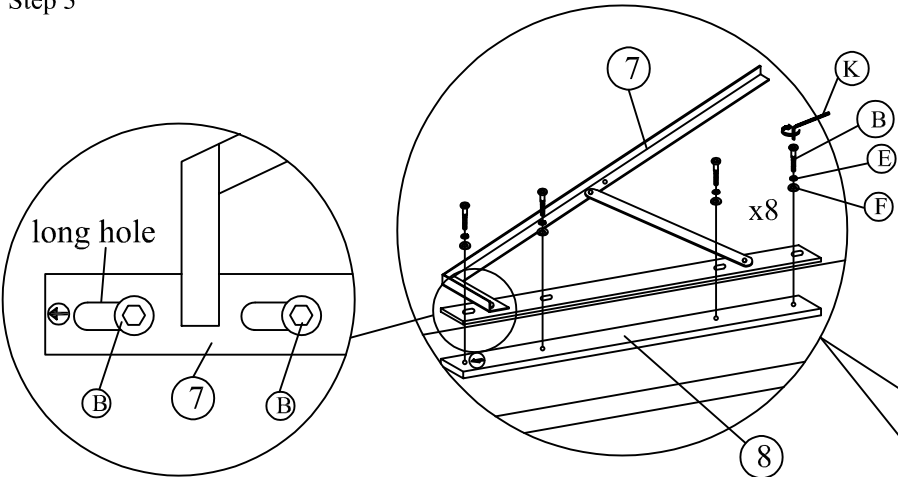

Caution: Tighten the screw at the position of the long hole as shown!

Step 3.1

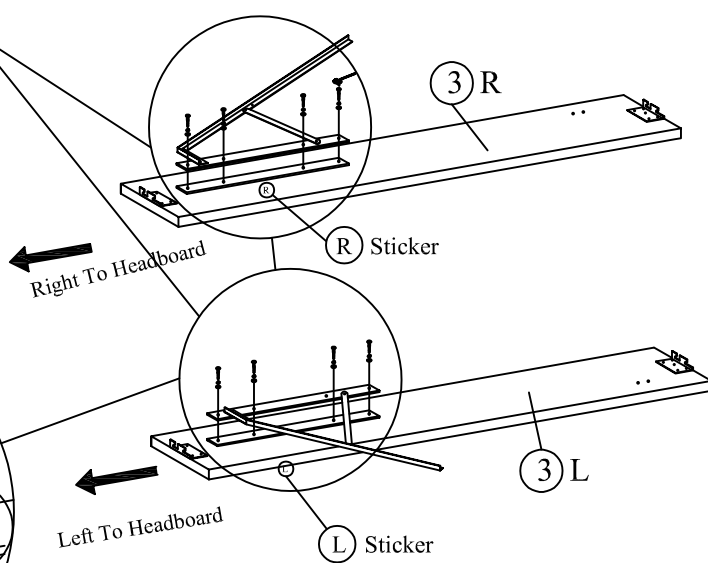

Step 3.2

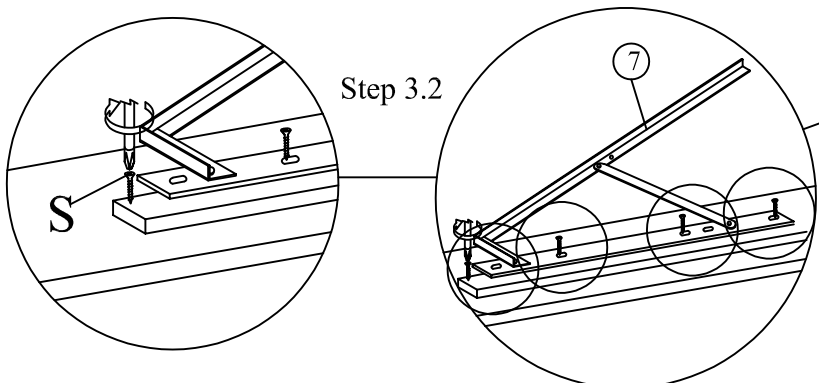

Step 4

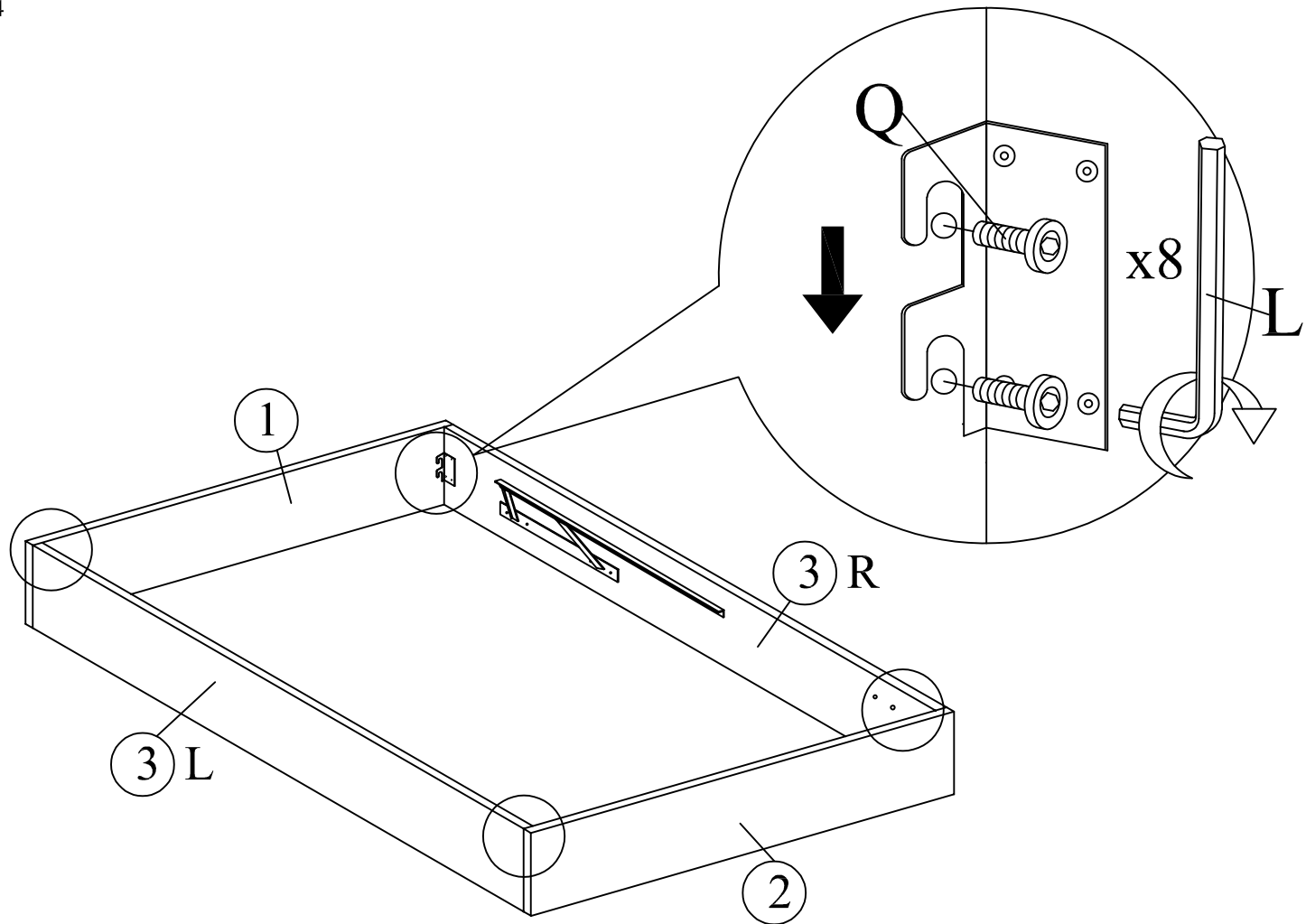

Step 5

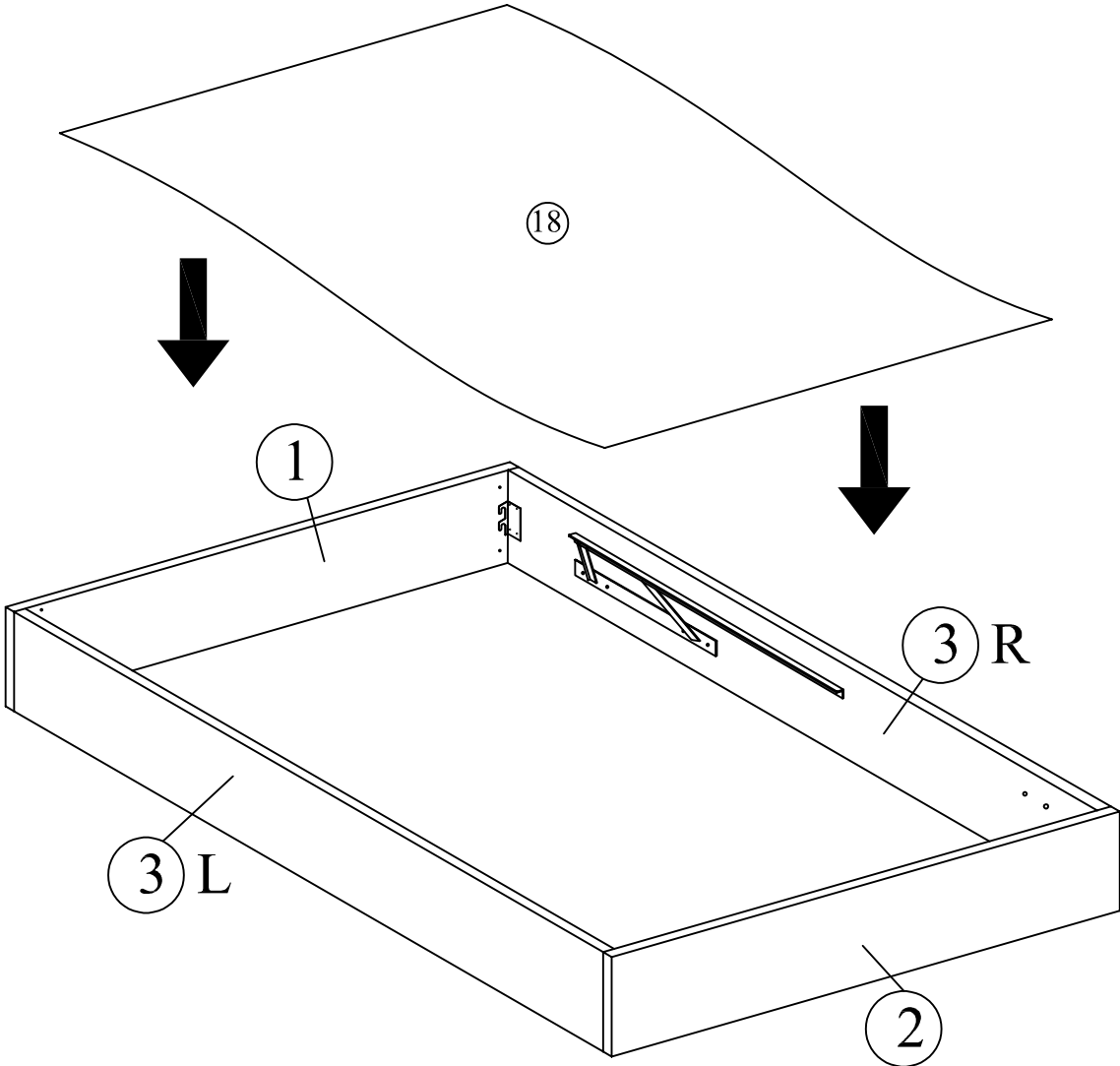

Step 6

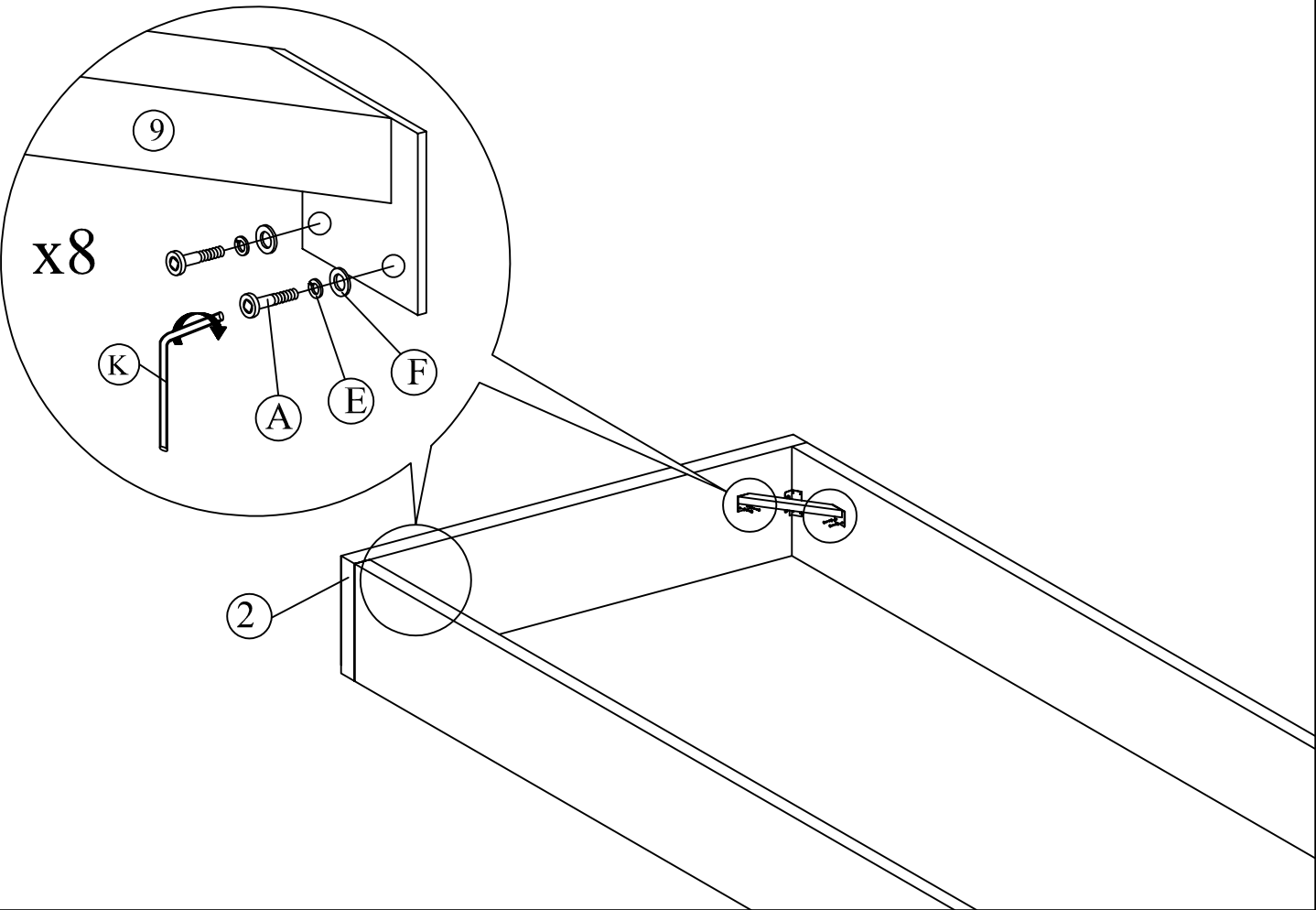

Step 7

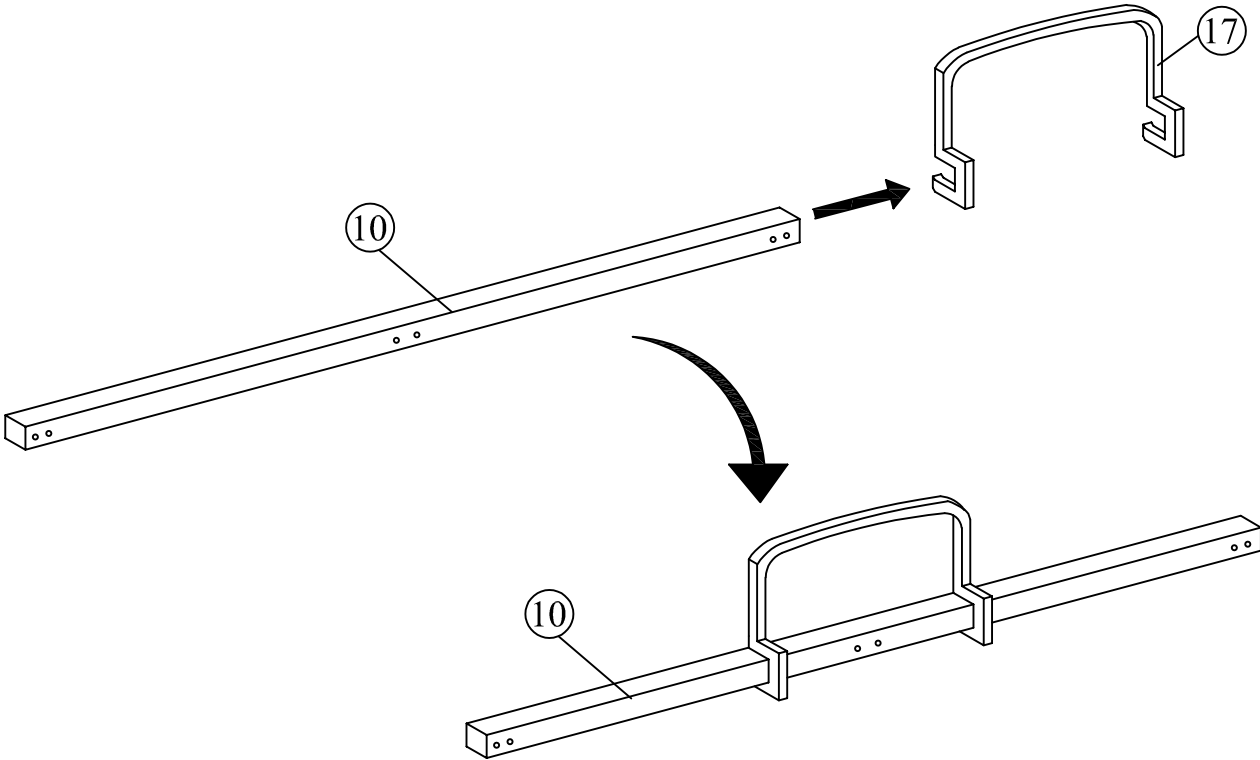

Step 8

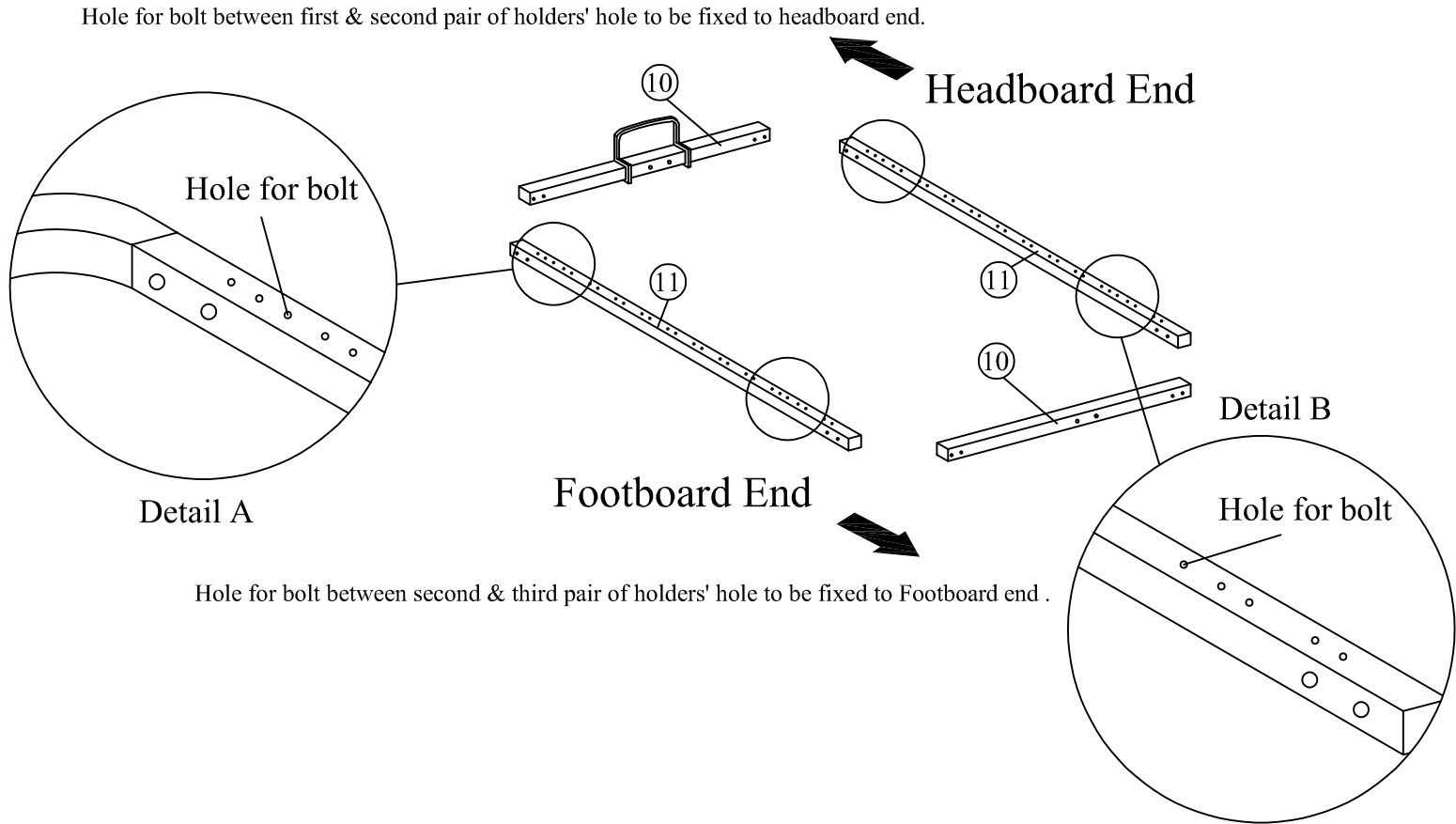

Step 9

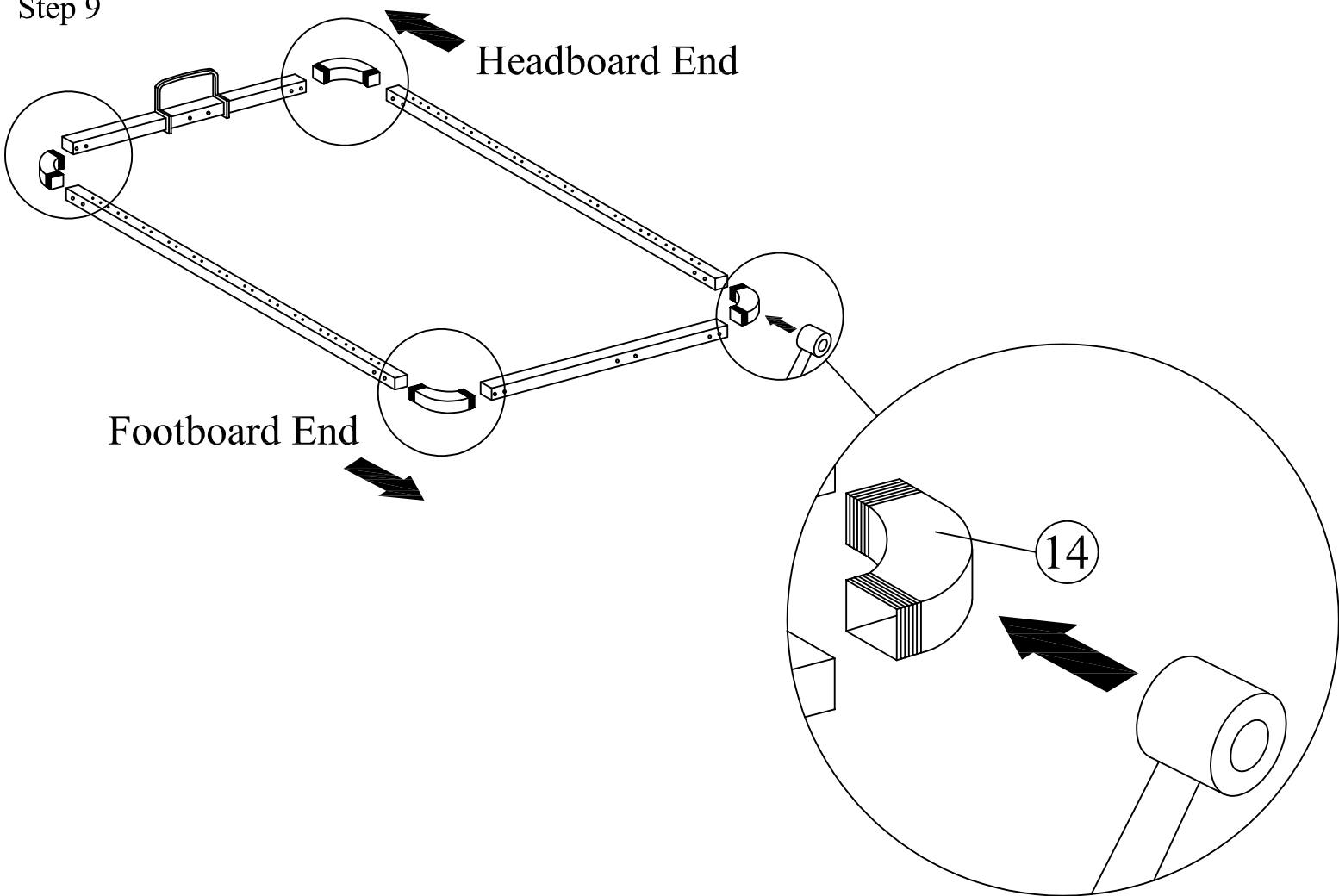

Step 10

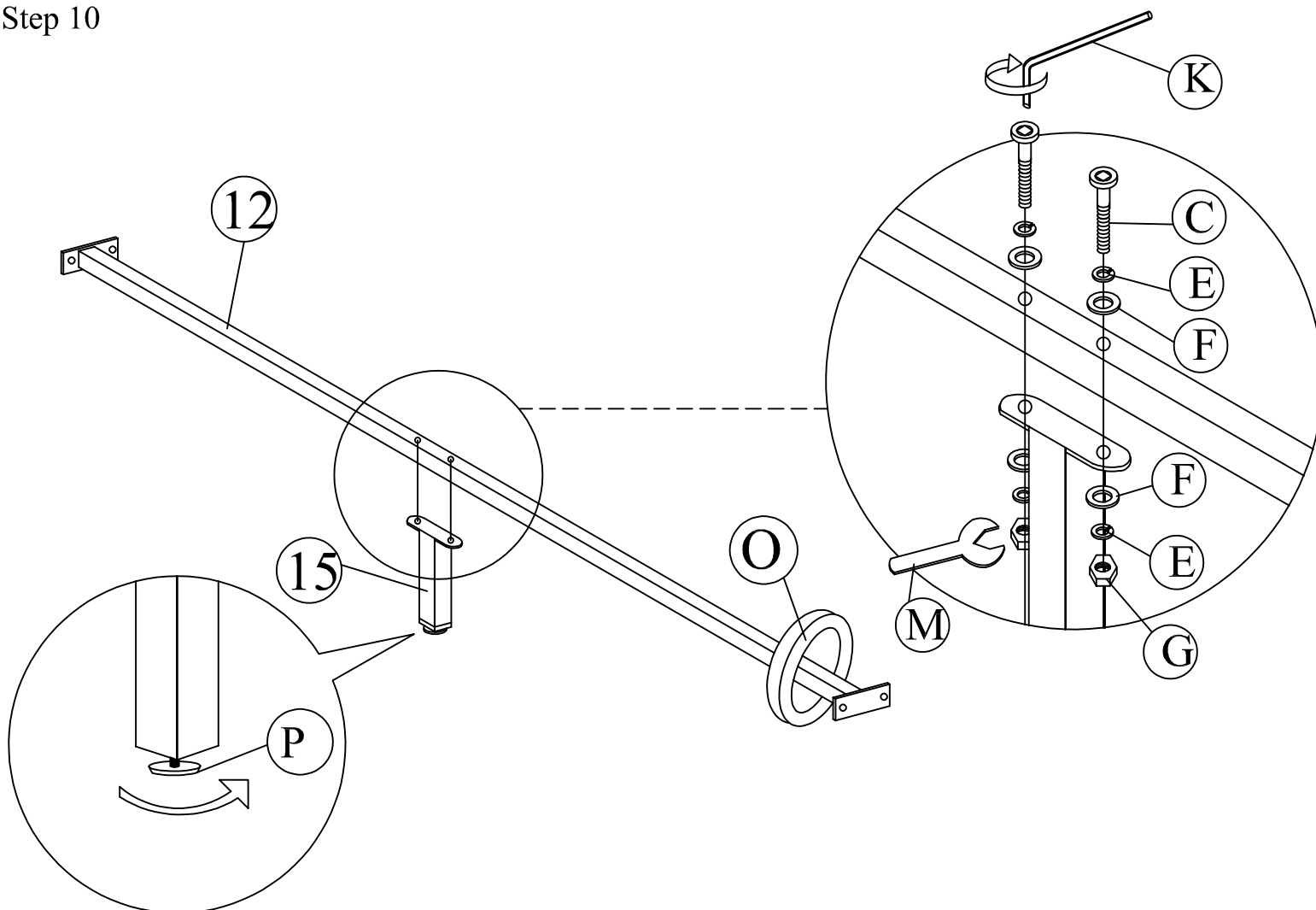

Step 11

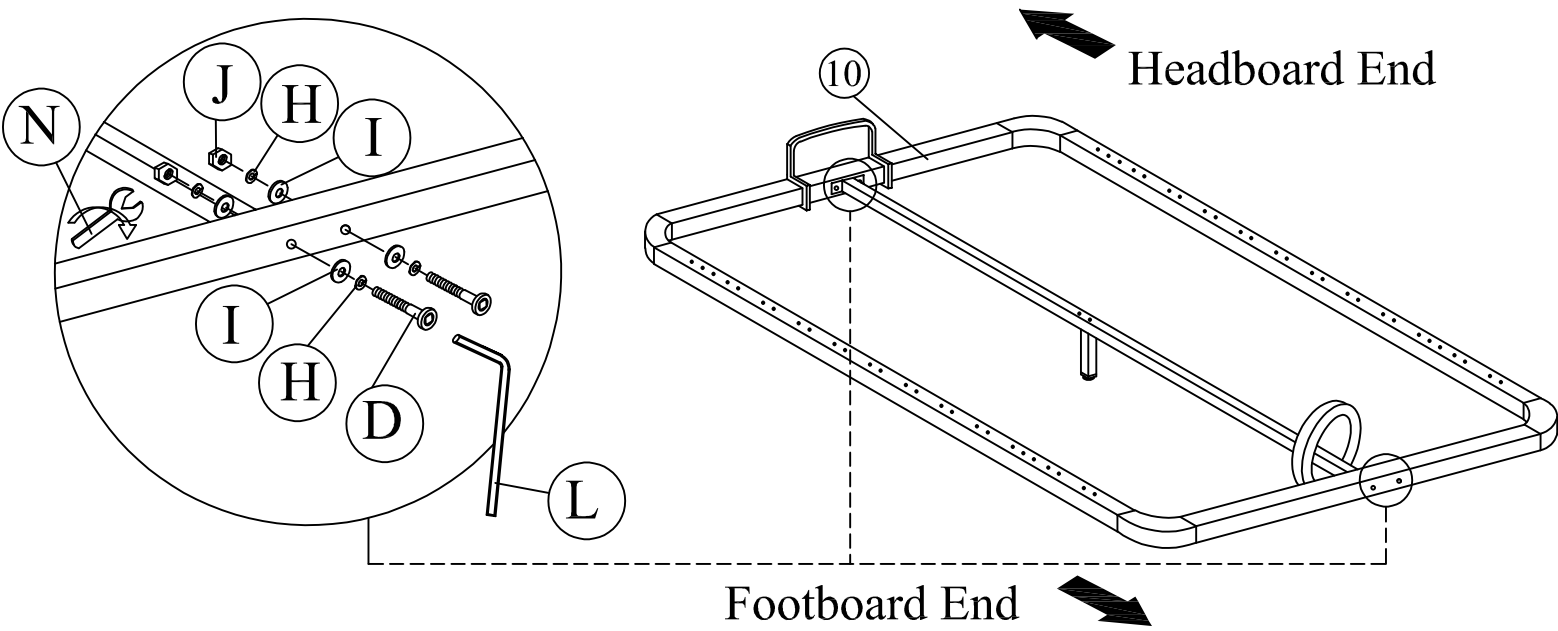

Step 12

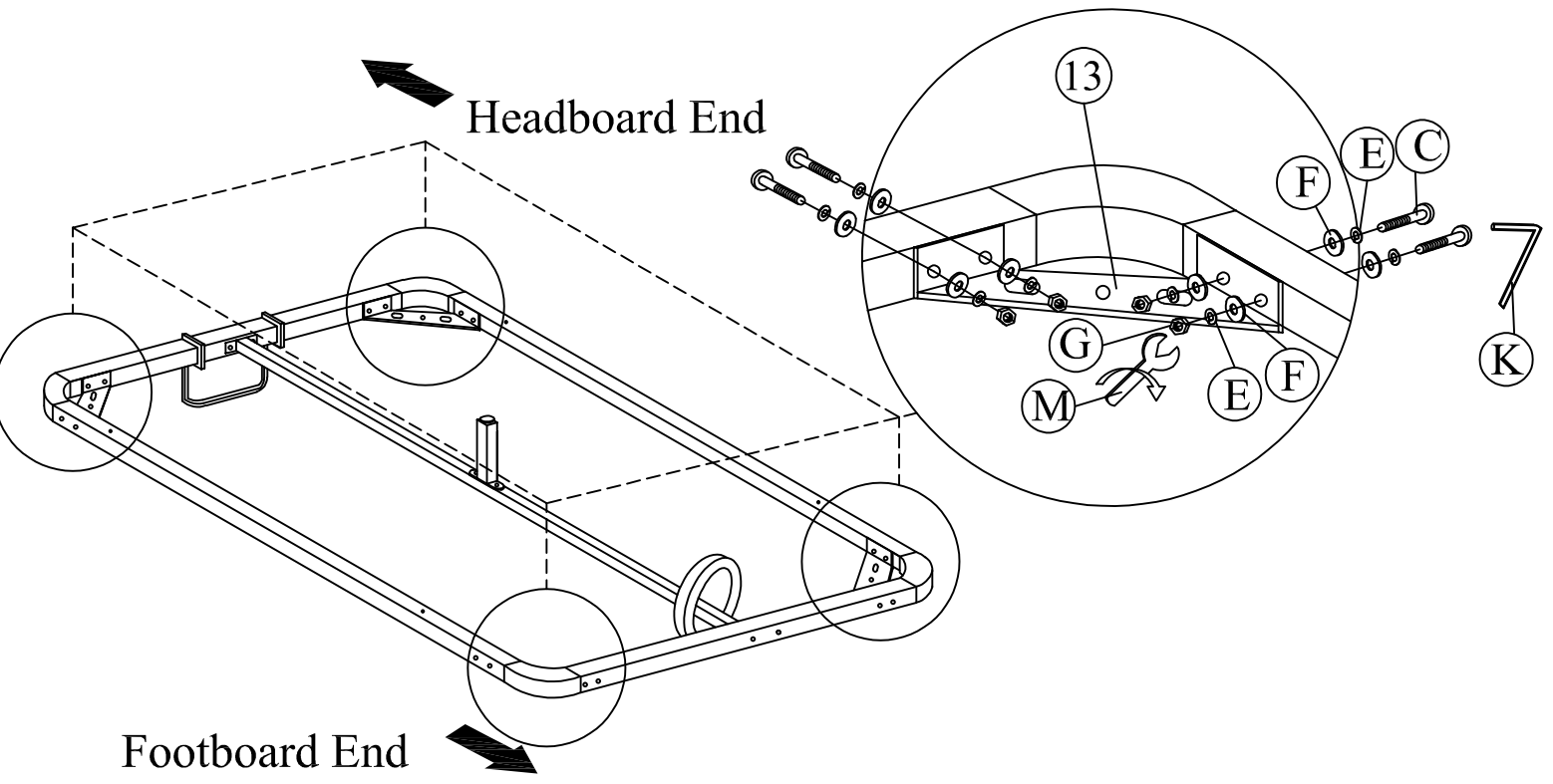

Step 13

Fit Slat Holders (4) first & attach to outside rail , then fit slat holders (5) and attach to center rail (Note : fit 4 first then 5)

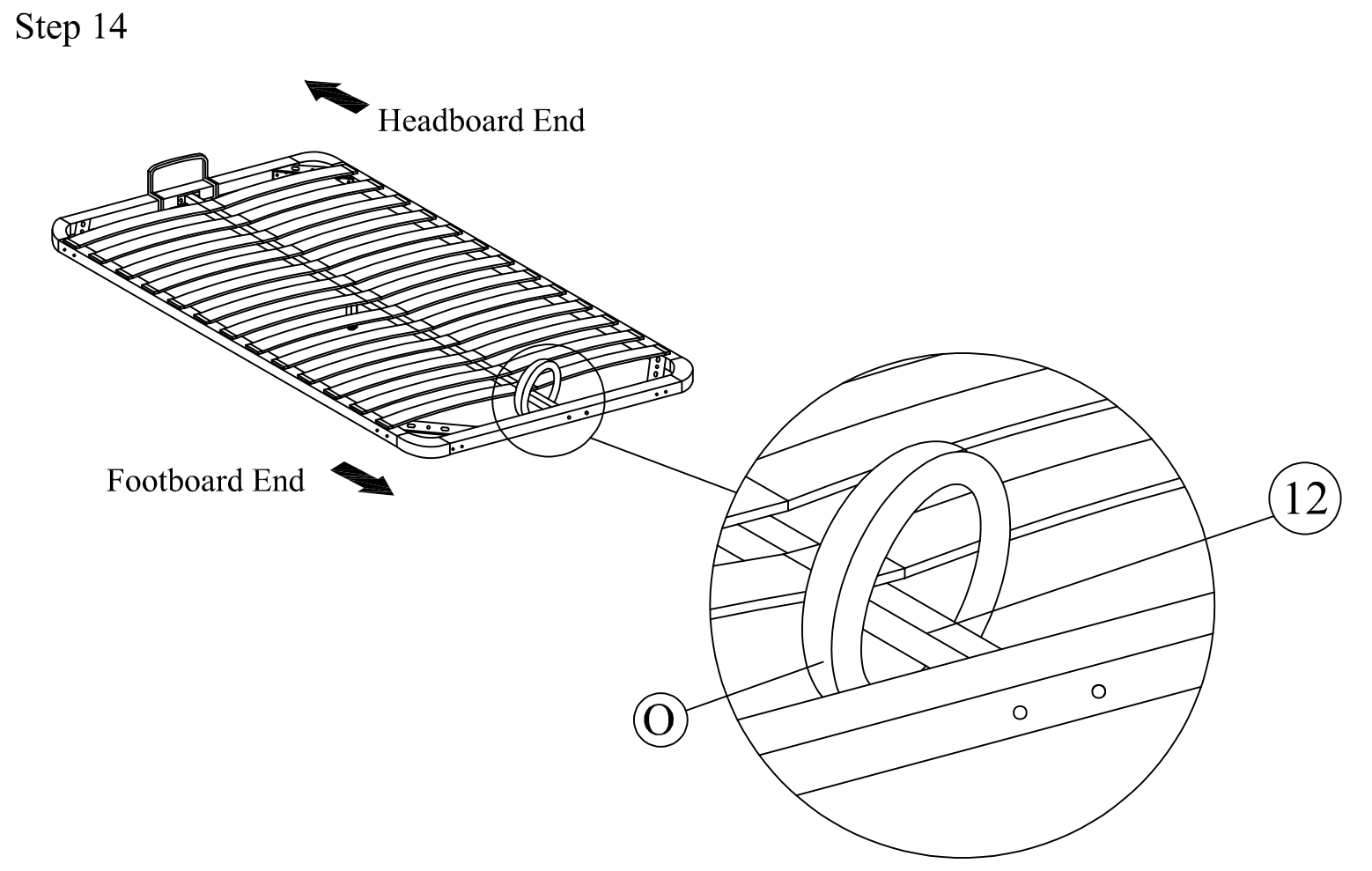
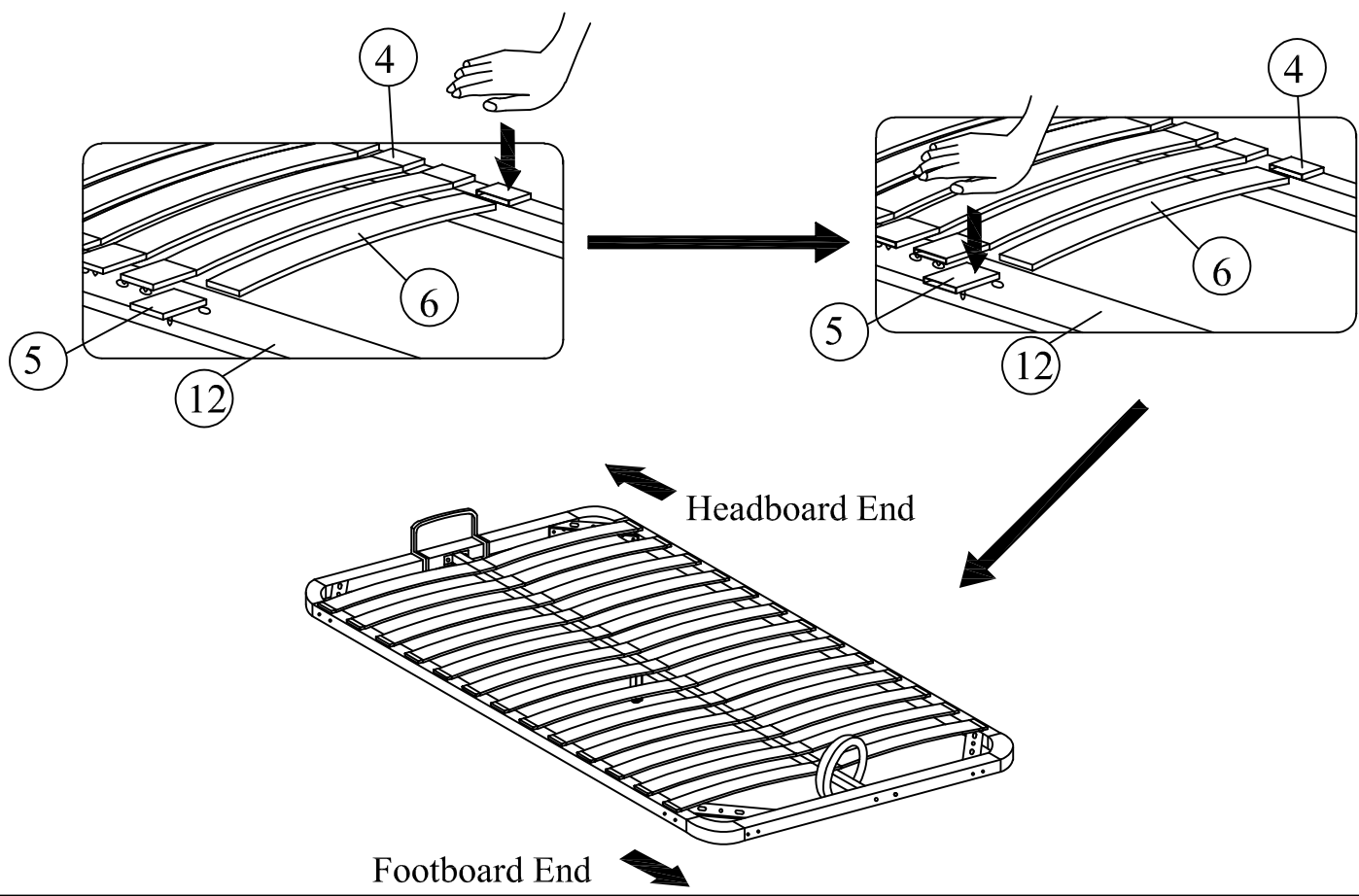

Step 15

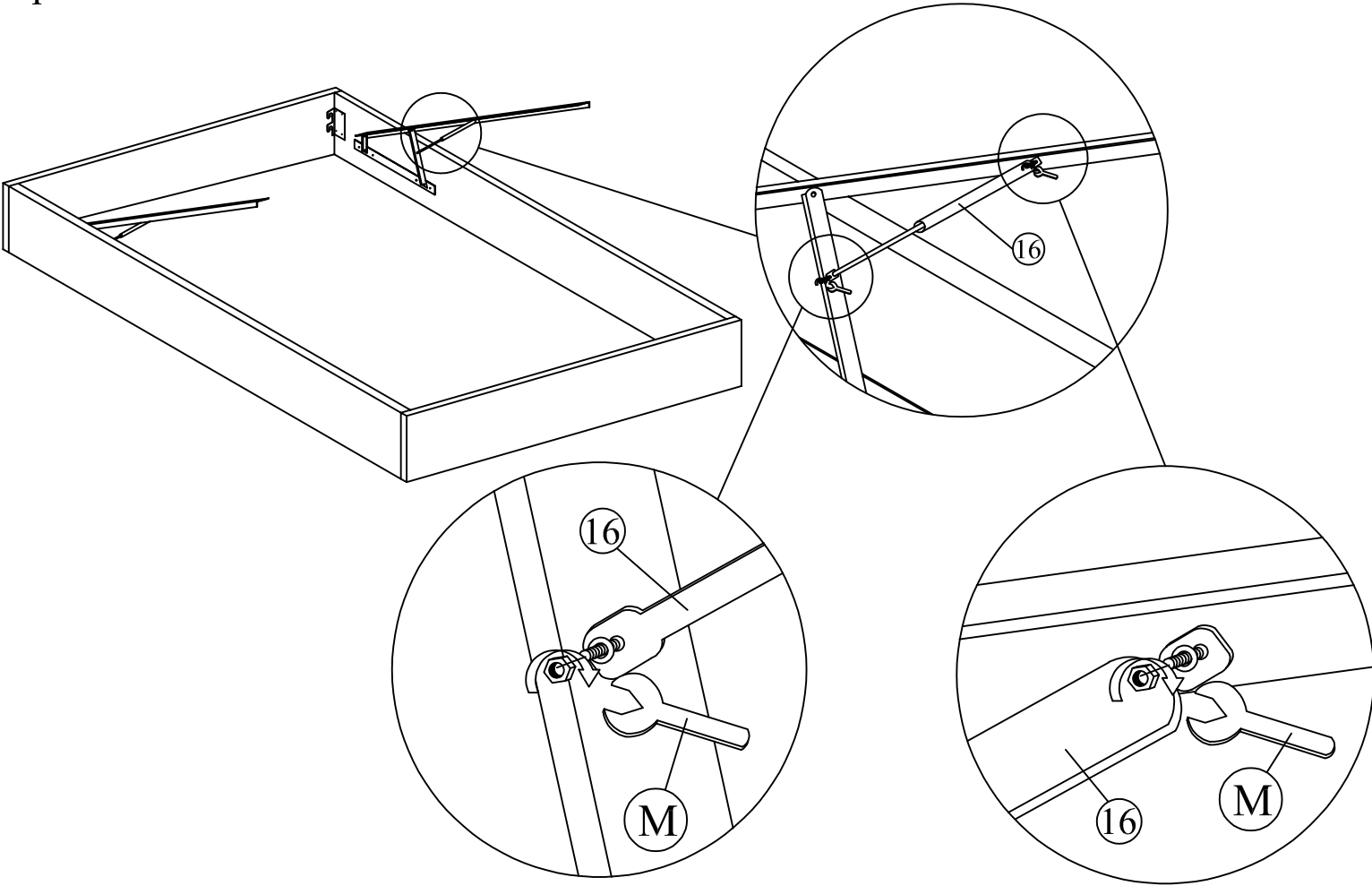

Step 16

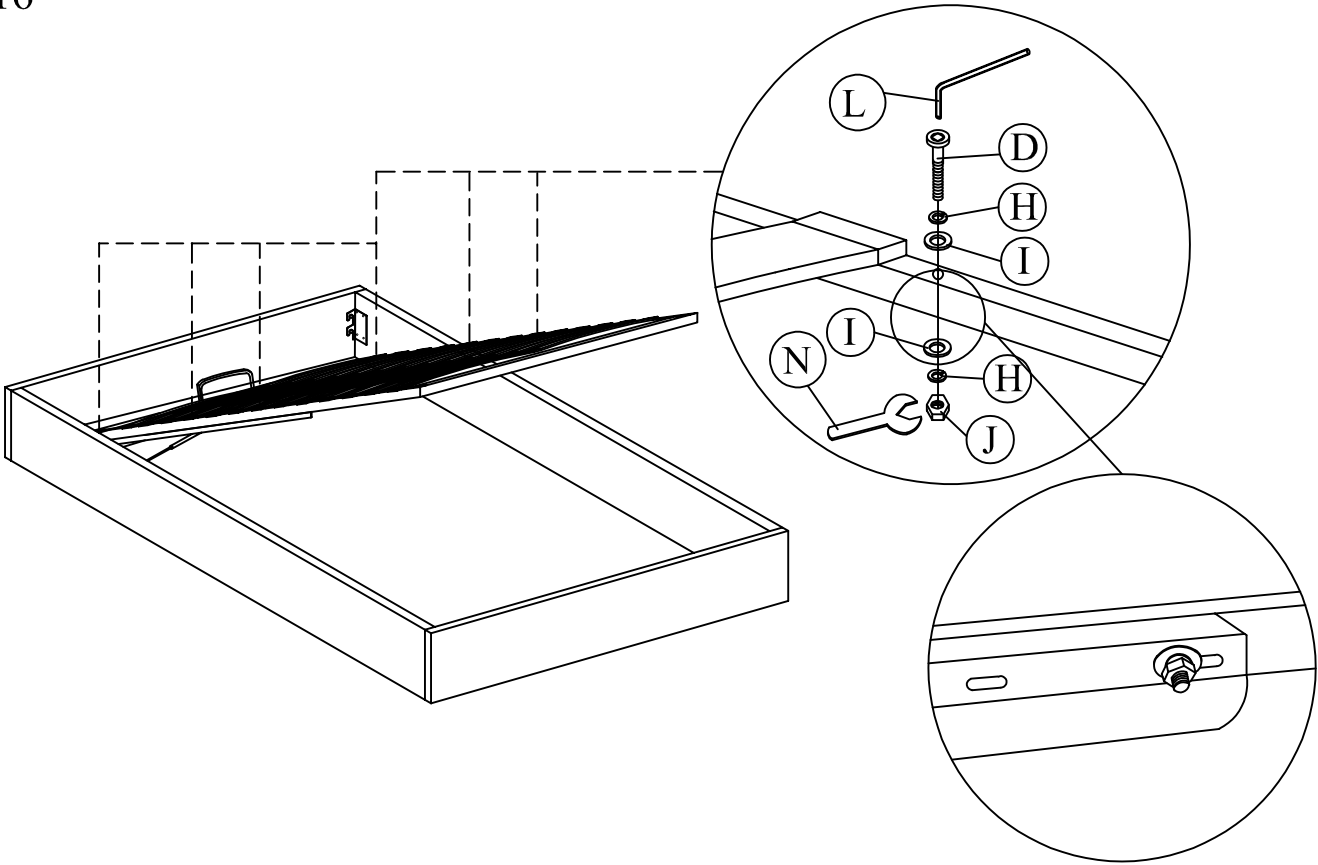

Caution: Adjust the screw at the position of the long hole as shown, then tighten the screw!

Additional Information:

- Caution. This bed uses a pressurised mechanism.
- Use caution when operating - Always use two hands at arm's length, and only where illustrated on the product.
- You must ensure the mattress is on the bed frame before lifting the mechanism - Failure to do so may result in injury.
- Please ensure Children and pets are kept away from the bed when operating the bed mechanism.
- If removing the mattress, make sure that the frame is secured as it could flip open.
- Only use the storage compartment when the frame is fully raised in the 'up' position.
- No children and animals are left unattended when the frame is in the 'up' position.
- Do not remain on the bed whilst the lifting mechanism is in use.
- Beware of Entrapment - Keep both hands clear of mechanism when operating the mechanism.
- When lifting the bed remove all bedding - Except the fitted sheet.

